



Technical Data Sheet

Stirling Ultracold SU105UE Ultra-Low Temperature Freezer

Stirling Ultracold, Athens, Ohio USA

Specifications	Model Number
Application, Rating and Electric Data	
Application	Storage of general (non-flammable) laboratory materials
Storage Volume	105 liters (3.7 cu.ft.)
Storage Capacity	72 standard 2" boxes in optional racks, available separately
Temperature Range	-86°C to -20°C @ 32°C (90°F) ambient, adjustable to 1°C increments
Electric Power	100V to 240V (±10%) at either 50 or 60 Hz
Maximum Power (Current)	300 watts (3 amps @120V, 1.5 amps @240V) (±10%) at either 50 or 60 Hz
Auto-Voltage Capability	100V to 240V, 50 or 60 Hz
Electric Supply Rating	15 amp or greater grounded circuit
Power Plugs Available	NEMA 5-15P plug requires standard NEMA 5-15R receptacle (120V); Length: 2261 mm (89 in.), or NEMA 5-15P plug requires standard NEMA 5-15R receptable (120V); Length: 3048 mm (120 in.), or NEMA 6-15P plug requires standard NEMA 6-15R receptacle (240V); Length: 2997 mm (118 in.) <i>Specify when ordering</i>
Certification/Agency Listing	CE
Noise	Advanced noise abatement, <48 dB(A) at 1 meter
Indoor/Outdoor Use	Indoor use only
Application Environment	Non-corrosive, non-flammable, non-explosive
Ambient Operating Temperature	5°C to 35°C (41°F to 95°F)
Useful Life	12 years
Refrigeration System	
Cooling Engine	Helium charged free-piston Stirling engine with continuous modulation
Heat Transport System	Gravity driven thermosiphon
Refrigerant	R-170 (Ethane) 30 - 33 grams
Evaporator	Cold wall (inner liner)
Heat Rejection	Finned heat exchanger with forced air cooling Air inlet: Above freezer door, below mechanical compartment Air outlet: Underneath of rear right corner bottom
Defrost Method	Manual
Controller	
Interface	Graphic user touchscreen interface
Controller Type	Microprocessor with touchscreen input and display
Security	Lockable door Optional PIN requirement built in
Warm and Cold Alarms	Fully adjustable
Control Sensor	Two RTDs (PT100 Class A)
Event Log	All alarms, door openings
Dry Contacts	Normally closed, normally open, common; activated by power outage or any alarm condition
Temperature Log	30 days available graphically
Battery Back-up	12 hour control battery back-up for touchscreen (6V lead acid battery)
Performance Data	
Steady State Energy Use	< 4 kWh/day at -80°C
Pull-Down from 25°C Ambient	9 hours to -80°C (empty cabinet)
Recovery from Door Opening (ENERGY STAR® Final Test Method)	40 minutes to -80°C
Warm-up Profile	2 hours to -60°C at -80°C (empty cabinet) 5.2 hours to -40°C at -80°C (empty cabinet)
Heat Dissipation	563 BTU/h (load to HVAC) at -80°C (empty cabinet)

	Model Number
	Stirling Ultracold SU105UE
	Dimensions and Construction
Interior (H x D x W)	533 x 432 x 457 mm (21 x 17 x 18 in.)
Exterior (H x D x W)	864 x 711 x 686 mm (34 x 28 x 27 in.)
Net Weight, Empty	100 kg (220 lbs.)
Shipping Dimensions (H x D x W)	1041.4 x 787.4 x 787.4 mm (41 x 31 x 31 in.)
Shipping Weight	121 kg (266 lbs.)
Insulation	High performance vacuum insulated panels and polyurethane foam using Ecomate® environmentally-friendly, SNAP-compliant blowing agent
Gasket Heater	User programmable duty cycle
Shelves	1 stainless steel, fixed position (removable)
Options	Chart recorder, international plugs

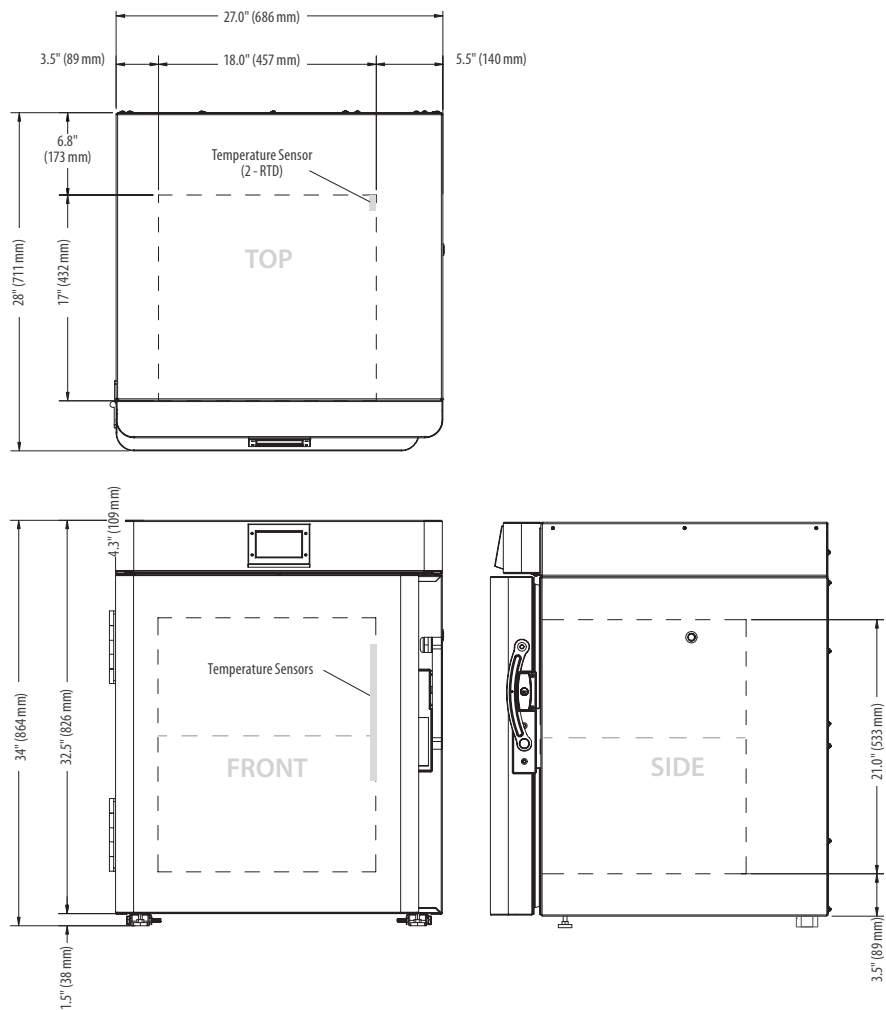

©2019 Stirling Ultracold, Global Cooling, Inc. All Rights Reserved.
 Global Cooling technology is manufactured under U.S. and International patents.
 Stirling Ultracold is a trademark of Global Cooling, Inc.
 Specifications subject to change without notice. Refer to www.stirlingultracold.com for the latest specifications.